

# **Raster Link 7**

(Ver.3.3.3 or later)

## **Job Creator guide**

MIMAKI ENGINEERING CO., LTD.

D203868-11

# Table of Contents

Introduction .....	<a href="#"><u>3</u></a>
Job Creator .....	<a href="#"><u>4</u></a>
1. Overview .....	<a href="#"><u>4</u></a>
2. Installing the Job Creator .....	<a href="#"><u>5</u></a>
3-1. Importing a Template .....	<a href="#"><u>7</u></a>
3-2. Creating a Template .....	<a href="#"><u>10</u></a>
4. Creating a Job .....	<a href="#"><u>15</u></a>
Supplementary Information 1 .....	<a href="#"><u>20</u></a>
Supplementary Information 2 .....	<a href="#"><u>21</u></a>
Supplementary Information 3 .....	<a href="#"><u>22</u></a>
Supplementary Information 4 .....	<a href="#"><u>23</u></a>

# Introduction

## **Note**

- Any unauthorized use or reproduction, in part or whole, of this manual is strictly prohibited.
- The information in this manual may be subject to change without notice in the future.
- Note that some of the descriptions in this manual may differ from the actual specifications due to improvements and revisions to this software.
- Copying Mimaki Engineering Co. Ltd. software described in this manual to other disks (except for the purpose of backup) or loading it to memory other than for the purpose of running it, is strictly prohibited.
- With the exception of what is provided in the warranty provisions, Mimaki Engineering Co. Ltd. does not assume any liability for any damage (including, but not limited to, the loss of profit, indirect damage, special damage, or other monetary damages) resulting from the use or inability to use this product. The same shall also apply to cases where Mimaki Engineering Co. Ltd. has been advised of the possibility of damage in advance. For example, we shall not be liable for any loss of media (work) caused by use of this product or indirect losses caused by products created using the media.

RasterLink is a trademark or a registered trademark of Mimaki Engineering Co. Ltd. in Japan and other countries. Microsoft, Windows, Windows 10, and Windows 11 are registered trademarks or trademarks of Microsoft Corporation in the United States and other countries.

Other company names and product names described in this manual are trademarks or registered trademarks of their respective companies.

# Job Creator

## 1. Overview

Job Creator can be directly launched from the RasterLink7 menu.

This tool allows you to create a RasterLink7 job by simply selecting a template and image.

For composite jobs that use special colors, this reduces the need to perform difficult operations on the RasterLink7 screen.

Templates can be obtained from the downloads section of our official website.

You can also create your own original templates from RasterLink7 backup job files.

# Job Creator

## 2. Installing the Job Creator

When RasterLink7 is installed, Job Creator is also installed with it.

<https://mimaki.com/product/software/rip/raster-link7/download.html>

# Job Creator

## 3-1. Importing a Template

### Workflow

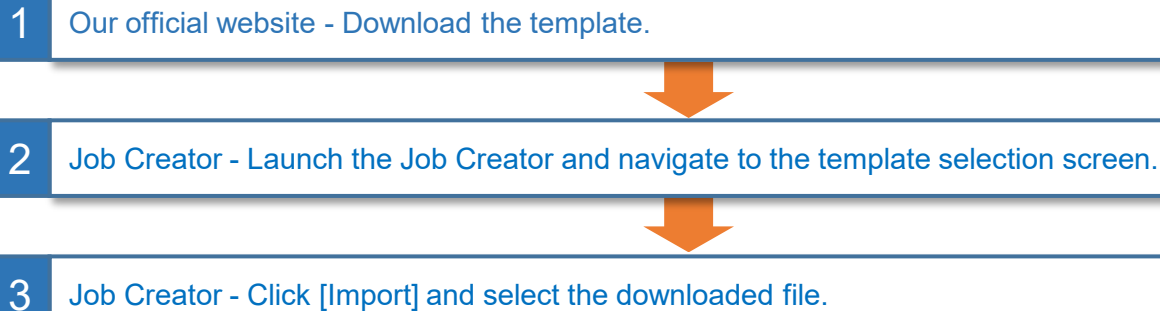
- 1 Our official website - Download the template.
  - 2 Job Creator - Launch the Job Creator and navigate to the template selection screen.
  - 3 Job Creator - Click [Import] and select the downloaded file.
- 

# Job Creator

## 3-1. Importing a Template

Procedure



Download the template for your printer from the RasterLink7 product page.

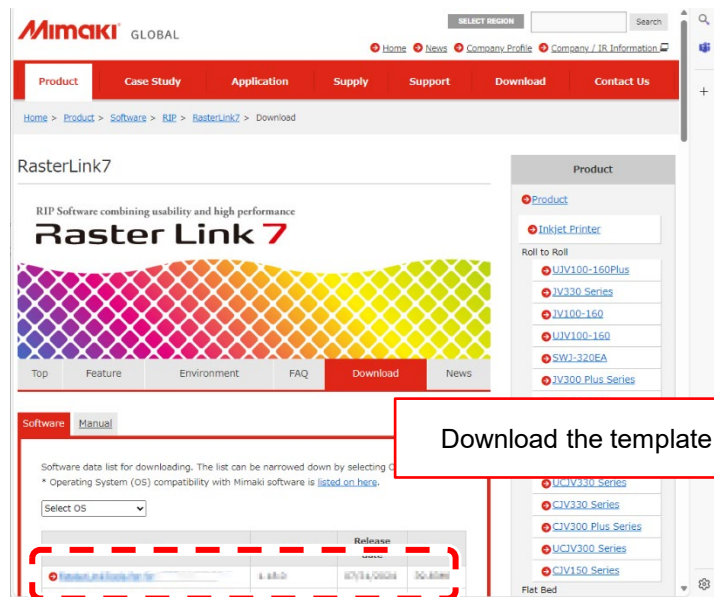

Download the template from the following URL.

<https://mimaki.com/product/software/rip/raster-link7/download-utility.html>

Alternatively, download it from your printer's [Product] site > [Download] > [Driver / Utility].

If there is no template for your printer on the above site, create a template from a backup job.

# Job Creator

## 3-1. Importing a Template

Procedure



Launch the Job Creator and navigate to the template selection screen.

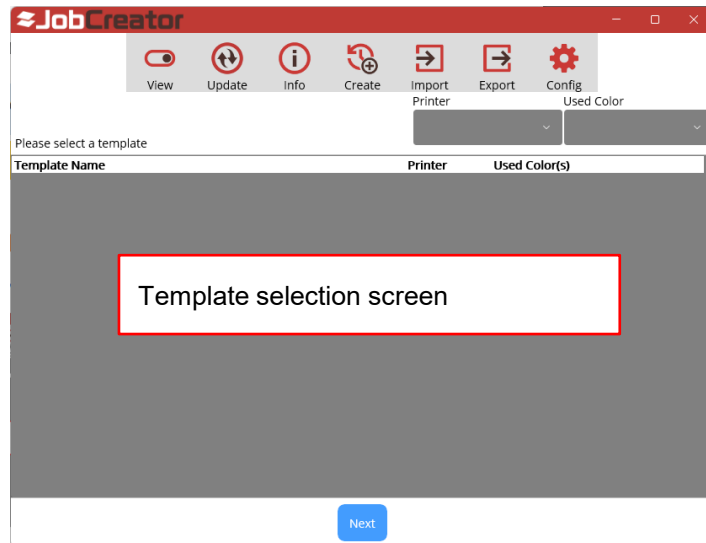

The Job Creator can be launched using one of the following methods:

- Select [Open(JobCreator)...] from the RasterLink7 [File] menu.
- Select the desired job in the RasterLink7 job list, right-click it, and then click [Recreate(JobCreator)...] from the context menu.



# Job Creator

## 3-1. Importing a Template

Procedure



Click [Import] and select the downloaded template.

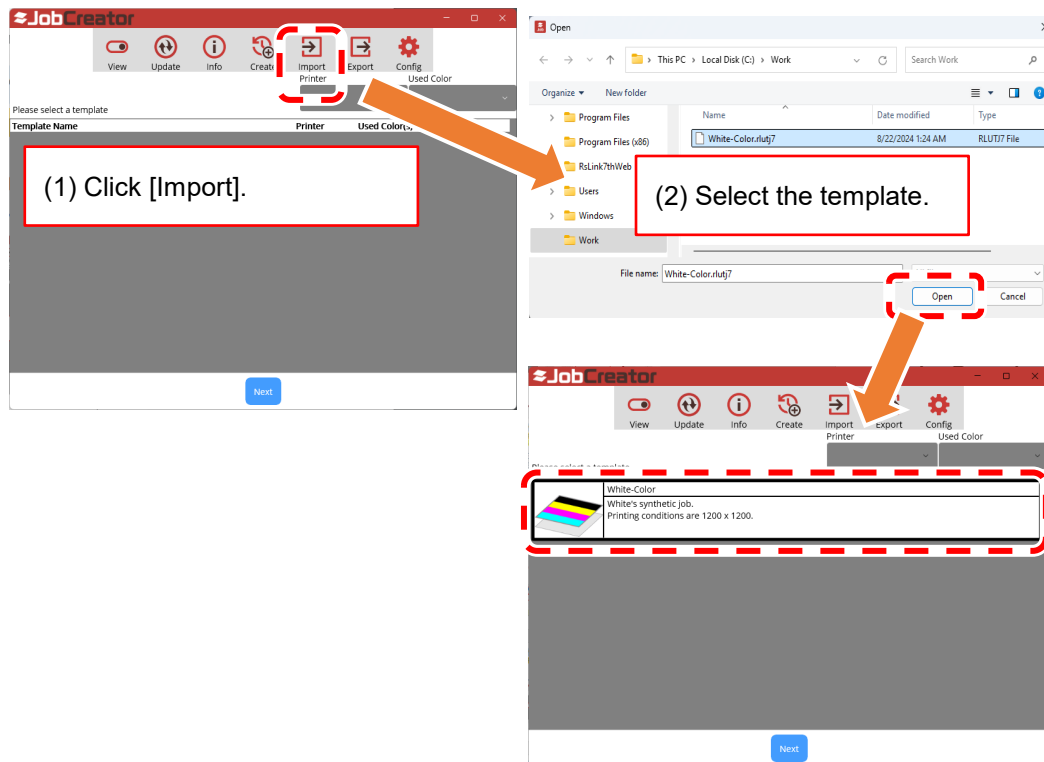

(3) The profile will be installed and the template will be added.  
Wait several seconds until the template is added to the template selection screen.

(4) The template is added to the template selection screen.

# Job Creator

## 3-2. Creating a Template

The following procedure can be used to create your own original template.

Before starting the procedure, create a job for the template in RasterLink7.

### Workflow

- 1 RasterLink7 - Create a backup job file.
  - 2 Job Creator - Launch the Job Creator and navigate to the template selection screen.
  - 3 Job Creator - Click [Create] and select the RasterLink7 backup file.
  - 4 Job Creator - Enter the template name and a memo, and then click [Save].
- 

# Job Creator

## 3-2. Creating a Template

Procedure



This example shows a white-to-color composite job.

Select a job for the template in the RasterLink7 job list and create the backup job file.

\*Be sure to create a backup job using RasterLink7 v3.3.3 or later.

Operation is not guaranteed if created with backup jobs prior to RasterLink7 v3.3.3.

(1) Select a job for the template.

Arranged	Layered	Thumbnail	Job Name	Attribute	Date
			kajiki.eps	Color	8/22/2024 2:46:47 AM
			kajiki.eps	WhitePlate Type	8/22/2024 2:47:02 AM
			kajiki.eps	Color	8/22/2024 2:47:08 AM
			kajiki.eps	ClearPlate Type(Glossy)	8/22/2024 2:47:17 AM
			kajiki.eps	Color	8/22/2024 2:47:23 AM
			kajiki.eps	Color	8/22/2024 2:47:29 AM
			kajiki.eps	PrimerPlate Type(Profile Setting)	8/22/2024 2:48:33 AM

(2) Click [Backup].

(3) Click [Save] to save the backup job file.

# Job Creator

## 3-2. Creating a Template

This example shows a white-to-color composite job.

Procedure



Launch the Job Creator and navigate to the template selection screen.

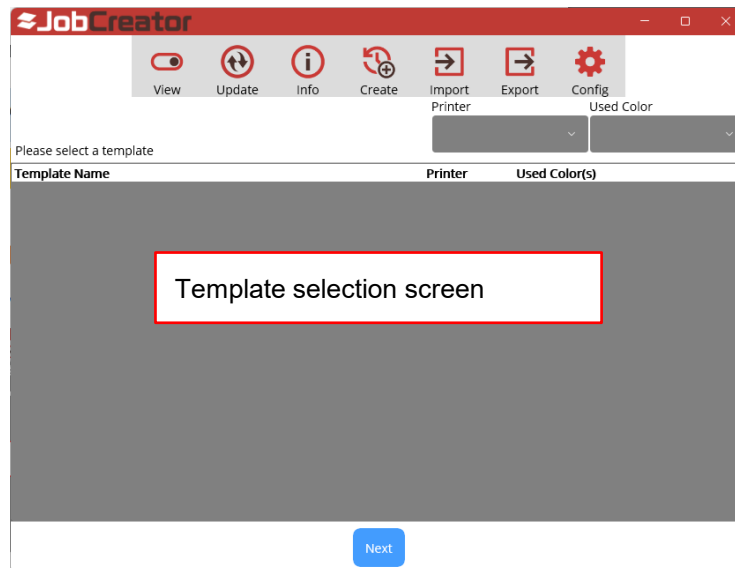

# Job Creator

## 3-2. Creating a Template

This example shows a white-to-color composite job.

Procedure



Click [Create] and then select the backup job file created in RasterLink7 v3.3.3 or later version.

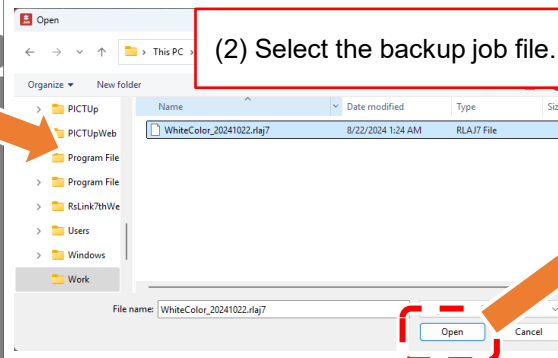

(4) The profile will be installed and a template created.  
Wait several seconds until the Job Creator screen changes.

# Job Creator

## 3-2. Creating a Template

This example shows a white-to-color composite job.

Procedure



Enter the template name and a memo, and then click [Save].

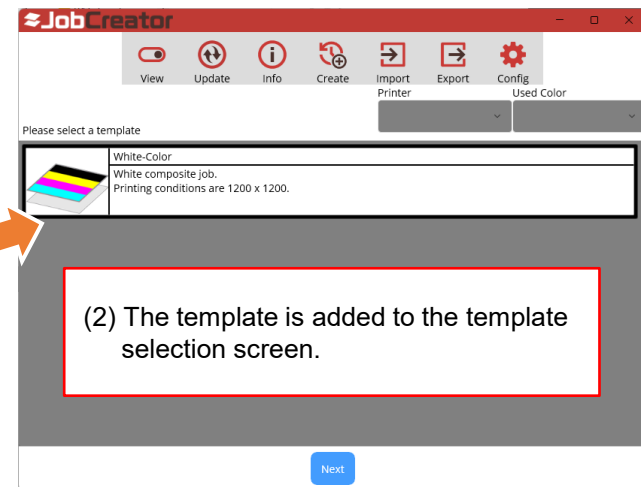
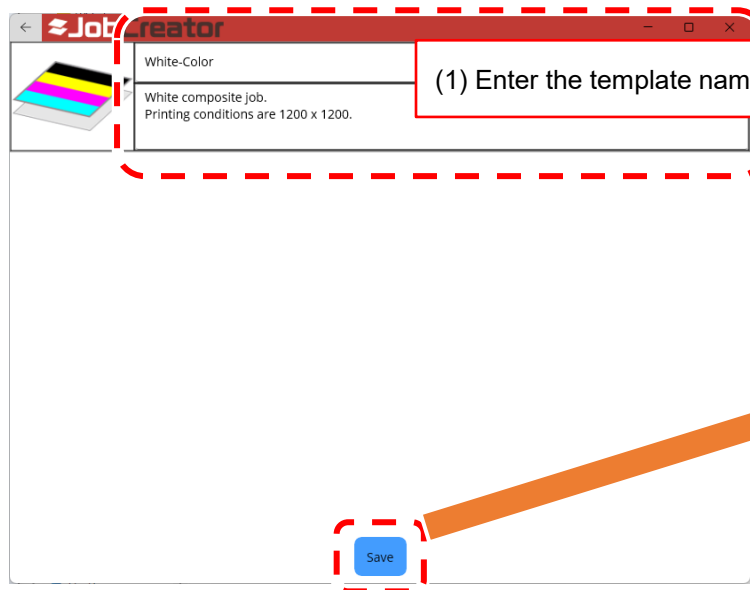

# Job Creator

## 4. Creating a Job

Create a job by selecting a template and an image file.

### Workflow

1 Job Creator - Launch the Job Creator, select a template, and then click [Next].



2 Job Creator - Select an image file on the job Create screen.



3 Job Creator - Drag and drop the image file onto the template.



4 Job Creator - Click [Create] to create the job.

# Job Creator

## 4. Creating a Job

This example shows a white-to-color composite job.



Launch the Job Creator, select a template, and then click [Next].

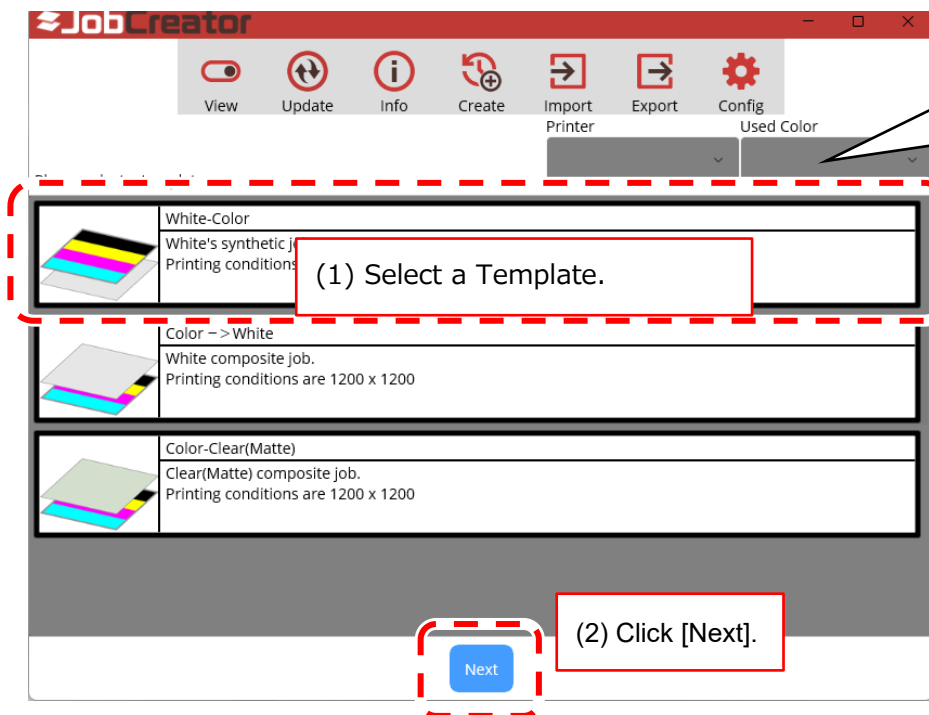

You can filter the templates to be displayed on the selection screen.

- Printer
- Special color



# Job Creator

## 4. Creating a Job

This example shows a white-to-color composite job.

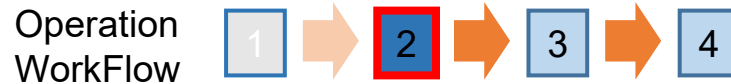

Click [Add Image], select the image file, and then click [Open].

(1) Click [Add Image].

White-Color  
White composite job.  
Printing conditions are 1200 x 1200.

Please input the image by drag and drop  
Ink : Fullcolor

Please input the image by drag and drop  
Ink : White | | Job Type : Special Plate | | Plate Type:Valid Pixel  
UV Mode : Panel setting

Copy Counts (Max: 999) 1

Create

For white-to-color composite job templates, the following layer structures are displayed:

- Color job
- White job

(2) Select the image file and click [Open].

name	Date modified	type	size
1.eps	9/19/2013 10:48 PM	EPS File	1,235 KB
2.eps	3/31/2021 12:33 AM	EPS File	1,953 KB
3.eps	7/14/2021 10:16 PM	EPS File	1,869 KB
4.eps	9/7/2021 10:13 PM	EPS File	1,888 KB
5.eps	9/7/2021 10:14 PM	EPS File	1,888 KB
6.eps	1/15/2020 6:19 PM	EPS File	2,691 KB
K.eps	6/12/2024 6:13 PM	EPS File	1,415 KB

File name: "K.eps" "1.eps" "2.eps" "3.eps" "4.eps" "5.eps" "6.eps"

Open Cancel

# Job Creator

## 4. Creating a Job

This example shows a white-to-color composite job.



Drag and drop the image file onto the template.

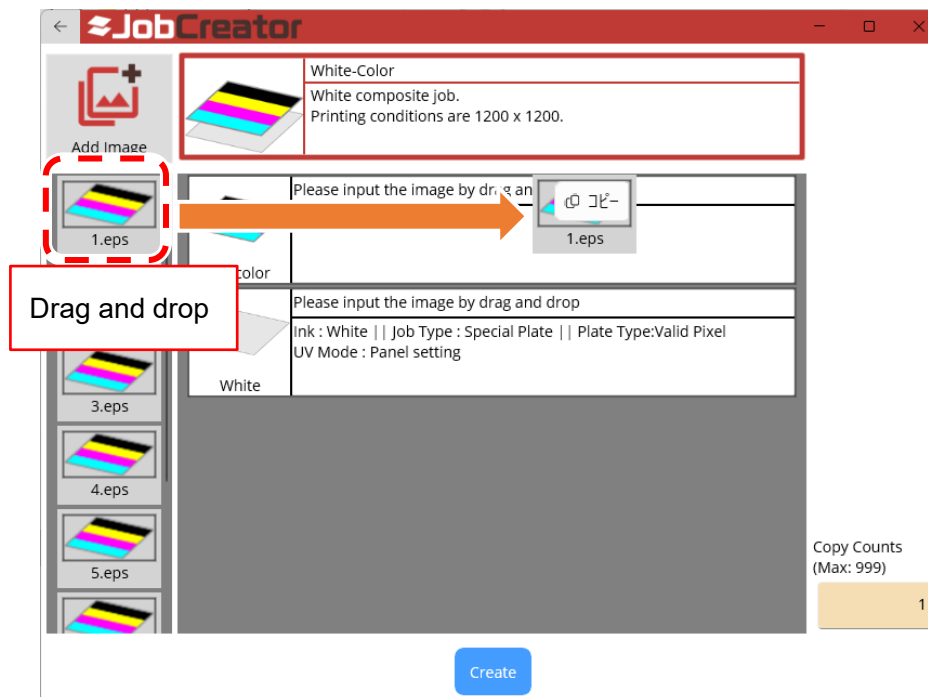

- In the case of a template for creating a special plate:  
If you drag and drop an image onto a color job, the same color image will be set to the white job.  
You can also drag and drop another image onto the white job.
- In the case of a template for monoreplace:  
It is necessary to drag and drop the image file onto both the color job and the white job.

# Job Creator

## 4. Creating a Job



This example shows a white-to-color composite job.

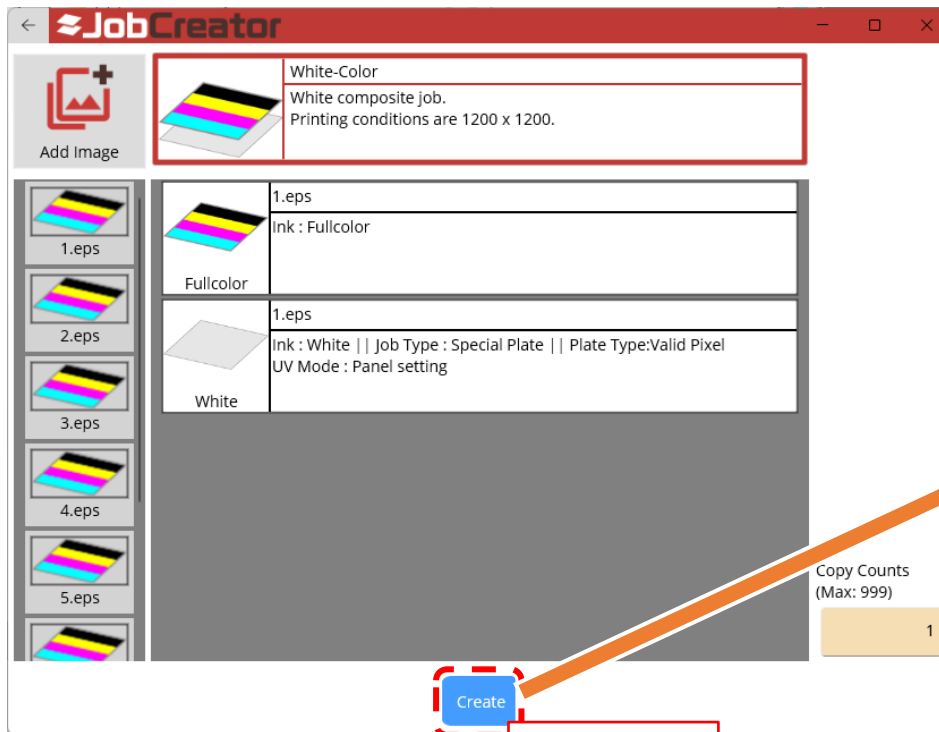

Click [Create].

After a few seconds, the job will be created and shown in the RasterLink7 job list.

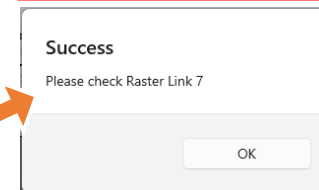

# Supplementary Information 1

The RasterLink7 settings that can be configured using a Job Creator template are as follows.

No.	Major item	Minor item	Favorite	Template
1	Properties	Job attribute (Monoreplace)	Yes	Yes
		Monoreplace using the alpha channel of a PNG file	No	Yes
		UV mode (Gloss, matte, emboss)	Yes	Yes
2	Quality	All items *2	Yes	Yes
3	General Print	Scale	Yes	Yes
		Rotation	Yes	Yes
		Mirror	Yes	Yes
		Deskew	Yes	Yes
		Cut line	Yes	Yes
		Arrange in the center	Yes	Yes
		Print area *2	Yes	Yes
		Register mark settings	Yes	Yes
		FOTOB settings	Yes	Yes
		XY slitter settings	No	Yes
		Label	Yes	Yes
4	Trimming		No	No
5	Tiling	Scale	Yes	Yes
		Tiling ON/OFF	No	No
		Rotation	Yes	Yes
		Mirror	Yes	Yes
		Overlap	Yes	Yes
		Overlap line	Yes	Yes
		Tile number	Yes	Yes
		Cut line	Yes	Yes
		Label	Yes	Yes
6	Step & repeat	Step & repeat ON/OFF	No	Yes
		Scale	Yes	Yes
		Rotation	Yes	Yes
		Mirror	Yes	Yes
		Arrange in the center	Yes	Yes
		Type	Yes	Yes
		Offset	Yes	Yes
		Reference line	Yes	Yes
		Label	Yes	Yes

No	Major item	Minor item	Favorite	Template
7	Execution times		Yes	Yes
8	Special plate	Ink	Yes	Yes
		Density	Yes	Yes
		Created area	Yes	Yes
		Special color automatic composite	Yes	Yes
		Composite order	Yes	Yes
		Delete original job after plate Creation	Yes	Yes
9	Layer settings	Special color layer settings	Yes	Yes
		Position correction	Yes	Yes
		Size correction	Yes	Yes
10	Jig printing *2	Jig ON/OFF	Yes	Yes
		Jig name	Yes	Yes
		Scale	Yes	Yes
		Rotation	Yes	Yes
		Mirror	Yes	Yes
11	Kebab print	Kebab ON/OFF	Yes	Yes
		Scale	Yes	Yes
		Rotation	Yes	Yes
		Mirror	Yes	Yes
12	Composite	Composite order	No	Yes
		Retract	No	Yes
13	Color replacement*1		No	No

\*1:

The Job Creator can only apply color replacement (color correction) settings to single-layer templates.

\*2:

Templates do not include the files shown below. If you wish to share a user template with another instance of RasterLink7, you must use the environment backup function or restore the backup job file to build the same environment.

- Jig definition file
- Device adjustment file
- Print area definition file
- Color adjustment file
- Device profile
- (Device profile calibrated using the Calibration Tool)

# Supplementary Information 2

Templates cannot be created from the following backup jobs.

- multiple pages
- Multilayer printing (Three-layer, Four-layer, Five-layer)
- Braille Printing
- 2.5D Texture Maker
- Variable Print

# Supplementary Information 3

Menu	Description
View	Toggles the template display.
Update	Updates RasterLink7 to the latest information.
Info	Displays detailed information for the template. It also allows you to delete templates.
Create	Creates a template from a RasterLINK7 backup job.
Import	Imports a template.
Export	Exports a template.

# Supplementary Information 4-1

Mimaki provide 12 types of templates for the UJV300DTF-75.

Provides a description of the template.



#	Printing method	Resolution	Additional Information
1	Clear -> Color -> Clear(Matte)	1200 x 1200	
2		300 x 900	
3		600 x 1200	
4		600 x 600	
5	White -> Color -> Clear(Gloss)	1200 x 1200	
6		300 x 900	※1 Show the MULTI icon
7		600 x 1200	
8		600 x 600	※1 Show the MULTI icon
9	White -> Color -> Clear(Matte)	1200 x 1200	
10		300 x 900	※1 Show the MULTI icon
11		600 x 1200	
12		600 x 600	※1 Show the MULTI icon

※ 1

If you are using template with MULTI icon, the job list in RasterLink7 will show four-layer composite job with a clear bottom layer. However, when printing, it will be printed as three-layer job (white -> color -> clear).



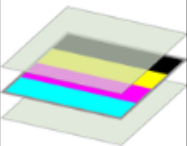
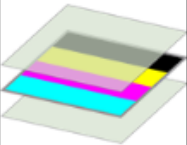
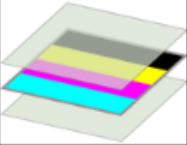
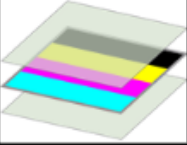
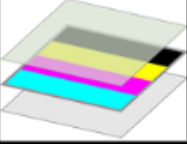



Adhesion is improved by ejecting special white plate made by mixing the bottom layer clear and the second layer white.

# Supplementary Information 4-2

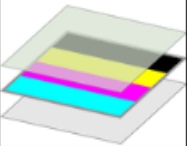
#	List display	Additional Information
1	 <p>UJV300DTF_ELS170_Clear-Color-Clear_HighQuality</p> <p>This template has the recommended conditions for Clear-Color-Clear 3-layer printing. Resolution: 1200x1200, Pass: 32 The top clear layer is corrected by +4 pixels using the "Special color size correction" function. This improves abrasion resistance.</p>	Top layer is Matte feel effect. Create a 3-Layer job
2	 <p>UJV300DTF_ELS170_Clear-Color-Clear_HighSpeed</p> <p>This template has the recommended conditions for Clear-Color-Clear 3-layer printing. Resolution: 300x900, Pass: 8 The top clear layer is corrected by +4 pixels using the "Special color size correction" function. This improves abrasion resistance.</p>	Top layer is Matte feel effect. Create a 3-Layer job
3	 <p>UJV300DTF_ELS170_Clear-Color-Clear_Quality</p> <p>This template has the recommended conditions for Clear-Color-Clear 3-layer printing. Resolution: 600x1200, Pass: 32 The top clear layer is corrected by +4 pixels using the "Special color size correction" function. This improves abrasion resistance.</p>	Top layer is Matte feel effect. Create a 3-Layer job
4	 <p>UJV300DTF_ELS170_Clear-Color-Clear_Standard</p> <p>This template has the recommended conditions for Clear-Color-Clear 3-layer printing. Resolution: 600x600, Pass: 12 The top clear layer is corrected by +4 pixels using the "Special color size correction" function. This improves abrasion resistance.</p>	Top layer is Matte feel effect. Create a 3-Layer job
5	 <p>UJV300DTF_ELS170_White-Color-ClearGloss_HighQuality</p> <p>This template has the recommended conditions for White-Color-ClearGloss 3-layer printing. Resolution: 1200x1200, Pass: 32 The top clear layer is corrected by +4 pixels using the "Special color size correction" function. This improves abrasion resistance.</p>	Top layer is Gloss feel effect. Create a 3-Layer job
6	 <p>UJV300DTF_ELS170_White-Color-ClearGloss_HighSpeed</p> <p>This template has the recommended conditions for White-Color-ClearGloss 3-layer printing. Resolution: 300x900, Pass: 8 The top clear layer is corrected by +4 pixels using the "Special color size correction" function. This improves abrasion resistance.</p>	Top layer is Gloss feel effect. Create a 4-Layer job

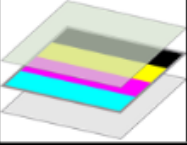

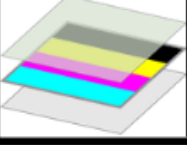
# Supplementary Information 4-3

#	List display	Additional Information
7	 <p>UJV300DTF_ELS170_White-Color-ClearGloss_Quality</p> <p>This template has the recommended conditions for White-Color-ClearGloss 3-layer printing. Resolution: 600x1200, Pass: 32 The top clear layer is corrected by +4 pixels using the "Special color size correction" function. This improves abrasion resistance.</p>	Top layer is Gloss feel effect. Create a 3-Layer job
8	 <p>UJV300DTF_ELS170_White-Color-ClearGloss_Standard</p> <p>This template has the recommended conditions for White-Color-ClearGloss 3-layer printing. Resolution: 600x600, Pass: 12 The top clear layer is corrected by +4 pixels using the "Special color size correction" function. This improves abrasion resistance.</p>	Top layer is Gloss feel effect. Create a 4-Layer job
9	 <p>UJV300DTF_ELS170_White-Color-Clear_HighQuality</p> <p>This template has the recommended conditions for White-Color-Clear 3-layer printing. Resolution: 1200x1200, Pass: 32 The top clear layer is corrected by +4 pixels using the "Special color size correction" function. This improves abrasion resistance.</p>	Top layer is Matte feel effect. Create a 3-Layer job
10	 <p>UJV300DTF_ELS170_White-Color-Clear_HighSpeed</p> <p>This template has the recommended conditions for White-Color-Clear 3-layer printing. Resolution: 300x900, Pass: 8 The top clear layer is corrected by +4 pixels using the "Special color size correction" function. This improves abrasion resistance.</p>	Top layer is Matte feel effect. Create a 4-Layer job
11	 <p>UJV300DTF_ELS170_White-Color-Clear_Quality</p> <p>This template has the recommended conditions for White-Color-Clear 3-layer printing. Resolution: 600x1200, Pass: 32 The top clear layer is corrected by +4 pixels using the "Special color size correction" function. This improves abrasion resistance.</p>	Top layer is Matte feel effect. Create a 3-Layer job
12	 <p>UJV300DTF_ELS170_White-Color-Clear_Standard</p> <p>This template has the recommended conditions for White-Color-Clear 3-layer printing. Resolution: 600x600, Pass: 12 The top clear layer is corrected by +4 pixels using the "Special color size correction" function. This improves abrasion resistance.</p>	Top layer is Matte feel effect. Create a 4-Layer job



D203868-11-31072025

© 2025 MIMAKI ENGINEERING CO., LTD.

SW